

RETROFIT Improvements

Whole-House Surge Protection

Making
Homes
Safer in
Disasters

Retrofit Opportunity

- The addition of whole-house surge protection is a project that can be taken on at anytime, without any other remodeling agenda

Purpose

- To protect electronics from power surges caused by lightning and transformer malfunctions

Benefits

- Prevents equipment and appliance damage from power surges

Hazards

Wind



Rain



Flood



Seismic



Fire



Snow



Summary

The electronic devices used in your home are extremely sensitive to power surges. Power surges can occur when lightning strikes near a power line or when a transformer malfunctions. Power surges can damage your electronic equipment or anything else in your home that has a microchip, such as your security system and portable phones. To protect your home and equipment from a power surge, install a whole-house surge protector.

Illustration

Retrofit

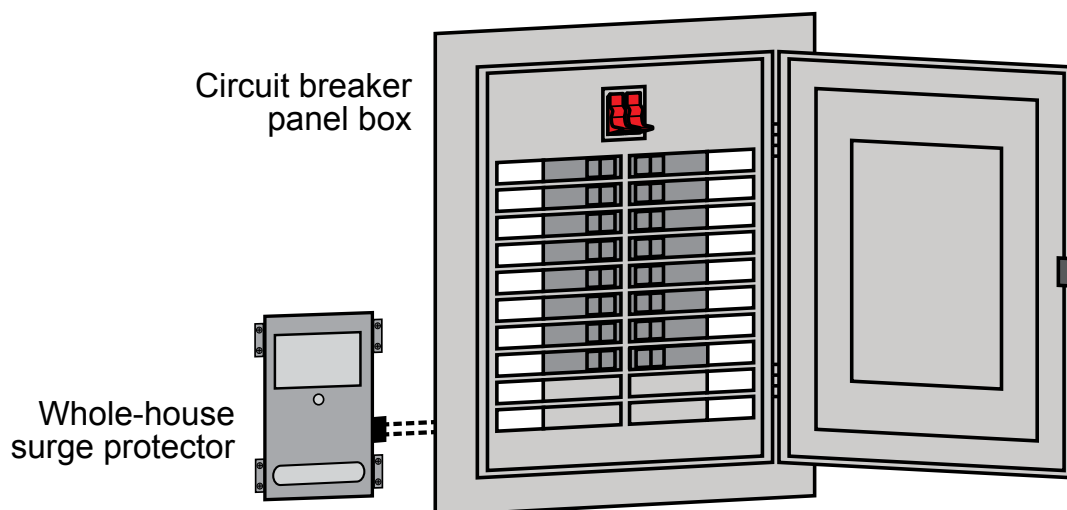

Potential Damage



Photo: www.fema.gov

Key Steps

- This retrofit requires a licensed electrician.
- Your utility company may have more information on whole house surge protection.
- Your contractor may have additional ideas on how to improve the safety of your home.
- For more details about this retrofit improvement, please refer to the list of Resources in the section below.

Resources

Insurance Institute for Business & Home Safety, *Lightning Protection*
<http://www.disastersafety.org/project?projectId=3902>

